

Reflections

THE FRANK H. KENAN CHAPEL

DECEMBER 2008

FROM THE PRESIDENT

Board of Directors

Austin L. Newsom,
President

Kenneth L. Garrett,
Vice President

Stan Nawrocki,
Treasurer

Anne P. Leister,
Secretary

Betsy Balas

Patricia J. Bell

Willis D. Brown

Janet E. Burkholder

Frederick W. DeTurk

Christine B. Farley

Dr. R. V. Fulk, Jr.

Katharine Keenan

Marlyn Sager

William J. Schild

William A. Stauffer

Founders

Frank & Betty Kenan

Director Emeritus

Thomas S. Kenan III

Honorary Director

Paul Davis Boney

By Al Newsom, President

It has been seven years since the Kenan Chapel was completed and dedicated on August 5, 2001 and given to our community by the Kenan family in honor of Frank H. Kenan. As owners of the Chapel for the community, the Board of Directors has been pleased with the activities and use of the Chapel during that time. The primary use of the facility has been for Weddings, Baptisms/Christenings, Memorial Services, individual Meditation and Prayer, and Concerts and Special Events. The Chapel's Memorial Garden has also served as a place for the scattering or burial of ashes. Although we review events of the past year in our annual newsletter, it is just as important to give thoughts to the future as well.

One future objective is to expand the community outreach of the Chapel, something that the Music and Events Committee has been hard at work on. We are proud to announce that in June of 2009 we will launch the Port City Chamber Music Festival in conjunction with two area churches. This series of three concerts will feature the Philadelphia Camerata, with one performance at the Chapel and an additional performance at each of the other two venues (see the Music article for further information).

Plans are under consideration by the Board for expansion and beautification of the Kenan Chapel Memorial Garden to include a walkway from the existing garden, through the wooded area to a



Labyrinth. The Labyrinth would enhance the beauty and serenity of the garden, and the ability to walk its pathway would provide further opportunity for peaceful reflection and meditation in a lovely outdoor setting. With the increased use of the garden by Landfall residents for Memorial Services and the scattering or burial of ashes, the Labyrinth could also provide an additional area in the garden for that purpose. A preliminary rendering of the proposed Labyrinth, created by Jack Leister, is shown on page 6.

I would be remiss not to thank the Landfall residents and surrounding community for their support and great generosity. Your volunteer work, contributions, and participation in our Annual Benefit Concert and Fall Festival are sincerely appreciated. One example of the tireless volunteer work is the years of service that Gerda and Wolfgang Strahl have given, continually planting seasonal flowers and maintaining our Memorial Garden with loving care. Thank you, Gerda and Wolfgang.

We hope Landfall residents will continue to consider the Kenan Chapel is an outstanding community asset. Our working Board is available to answer any questions, and we welcome any suggestions you might have for our future. We have no paid staff and depend on our many volunteers. If you desire to be a Chapel volunteer, please contact me or any Board Member. Al Newsom at 910-256-5727 or email alnewsom@earthlink.net. For further information visit our website at www.kenanchapel.com.



The Atlantean Trio

Save These Dates...

December 14, 2008
Christmas Music - Nancy King

January 18, 2009
Piano Recital - NC School of the Arts

February 8, 2009
Kenan Choral Scholars - UNC Chapel Hill

February 15, 2009
Guitar Quartet - NC School of the Arts

March 1, 2009
Flute & Piano - NC School of the Arts

April 19, 2009
Children's Classical Program, Papa Hayden,
and Barbara McKenzie

May 3, 2009
Violin Concert - Joby Brunjes, UNCW

June 14, 2009
Port City Chamber Music Festival
Philadelphia Camerata

MUSIC AT THE CHAPEL

Carrying out one of the primary missions of the Frank H. Kenan Chapel, the hard-working Music Committee is continuing to offer a series of free Sunday afternoon concerts that feature North Carolina emerging artists. A variety of exceptionally talented musicians played to packed audiences throughout 2008, culminating in the annual October fundraiser, where contributors were



once again treated to a rousing performance of operatic and popular selections by the A.J. Fletcher Opera Institute at the North Carolina School of the Arts followed by a gala dinner at the CCL Dye Clubhouse. This past year the Music Program expanded both in number of concerts and range of performers, and, in 2009, an even greater expansion is planned by the Music Committee, along with some exciting community outreach events. The Committee is co-chaired by Chris Farley and R.V. Fulk, Jr. and includes Peg Atkinson, Betsy Balas, Pat Bell, Barbara Burdett, Janet Burkholder, Blake Cardwell, Dick & Barbara Hopper, Anne Leister, Jim McGee, Frances McMillan, Stan Nawrocki, Al Newsom, Pete & Lou Shult, and Ginny Walker.

Working with the University of North

Carolina, the Chapel will host the Kenan Choral Scholars from UNC Chapel Hill; and another partnership, with Chamber Music Wilmington, will bring for the first time a Children's Classical Program, based on Papa Haydn. Organized by the Music Committee and sure to be a highlight of the summer season is the inaugural Port City Chamber Music Festival (June 14-16),

a series of three concerts by the Philadelphia Camerata to be held on successive evenings at the Kenan Chapel, Wrightsville Methodist Church, and First Presbyterian Church.

Tickets for the Chapel's Sunday evening concerts can be picked up at the Northeast Library Branch two weeks prior to each event. The tickets are free; however, donations are encouraged and accepted at the performances. Most concerts are followed by a small hors-d'oeuvre reception to meet the artists. The schedule of upcoming events available at press time is listed on this page, and, as other performances are confirmed, they will be posted on the Chapel website--www.kenanchapel.com-- as well as Landfall bulletin boards. For further information, call Chris Farley at 256-7475 or email christinefarley1@mac.com.

Fall Festival

By Marlyn Sager

The rainy weather on Saturday, October 11, did nothing to dampen the spirits of the Landfall community, which turned out in droves to support this eagerly anticipated annual event. Thanks to the heroic efforts of Steve Hughes and his staff of wonderful workers, everything--including a replica of Kenan Chapel--was set up in the COA facilities. Mr. Magic entertained children and adults alike with his fabulous balloon creations, the ponies of Wonderland Farms charmed everyone, the fire truck excited the young ones, and the atmosphere was festive with pumpkin and face painting. The smell of popcorn and hot dogs filled the air, and the sun was shining in everyone's smile and on all the pumpkin faces.



Festival proceeds go to support the Kenan Chapel and Great Oaks Club.



Callaghan-Barry
Wedding

Remembering Care Heeks



By Al Newsom

From the day our Board of Directors made the decision to present music programs at the Kenan Chapel, Care was a vital part of our effort to offer outstanding concerts for Landfall and the greater

Wilmington area. Her tireless efforts, great judgment, and many contacts were instrumental in attracting superior talent for our concert series and contributing to its great success. She devoted countless hours to our music programs during her six-year tenure and was a sterling example of a working Board Member.

Care was active in all phases of the Chapel activities. She had a particular interest in the Memorial Garden and provided guidance in its development and continuing maintenance, enjoying frequent walks there from her nearby home. The Board and I appreciate the many contributions Care made to the Chapel and our community. She is greatly missed by all.



EVENT ARRANGEMENTS

By Kate Keenan

The Arrangements Committee at the Frank H. Kenan Chapel is a very busy and involved group. Our availability to Landfall, greater Wilmington, and far-reaching communities beyond, has brought 35 brides to the Chapel in 2008. In addition, we have assisted with 3 christenings. Requests to hold christenings or baptisms at the Chapel are now coming from couples married there in earlier years! Since the Chapel's opening in 2001 all occasions of its use, including names and dates, have been and continue to be recorded by our scribes: John Farley and, more recently, Leslie Silloway. Memorial Services in both the Chapel and the Garden are noted as well. Many events have been filled to capacity, and our "chair" men--Dick Jones, Jim McGee, and Dick Kapsa--help with setting up and are on standby to assist the Committee comprised of Kate Keenan (Chair), Jeanette Baker, Kay Brockdorff, Barbara Brooks, Carolyn DeTurk,

Lynette Forrest, Suzanne Gram, Judy Larson, Pat Rathburn, and Kathy Tunks. The extensive rehearsal and wedding checklist followed by this conscientious crew assures that the Chapel continues to be well regarded in the community and beyond as the perfect venue for hometown or destination events. Anyone interested in becoming part of this very special group of volunteers, please email Kate Keenan at kate.keenan@att.net.



Chapel Cleaning Day:
Blake Cardwell &
Bill Schild (Property Management Chair)



Reese Mia Beausang
Christening

KENAN CHAPEL DONORS

November 1, 2007 - October 31, 2008

Our Sincerest Thanks!

DONATIONS \$1000 AND ABOVE

Erdody, Jack & Martha
Farley, John & Chris
Graff, Craig & Christine
Keenan, Rick & Kate
Kenan Family Foundation
Kenan III, Thomas S.
Kline, Bob & Rosemary
Landfall Foundation
Parker, David & Frances
Peterson, Nettie
Ruth Camp Campbell Foundation
Talbert Family Foundation*
Walker, Virginia
White, Mat & Pat*
Wingo, Richard

DONATIONS \$500 TO \$999

Anderson, Kenneth
Burkholder, Barry & Janet
Harding, Herbert & Joan
McCotter, Al & Joyce
Olds, Ned & Carol*
Olive, Betsy Ann
Phillips, Hank & Debbie
Socha, Leon & Deborah
Spencer, Everett & Mary Ann
Van Schaick, Anthony & Pat
Warwick, Bill & Jacqueline
Williams, Harry
Worsley Companies Inc.

DONATIONS \$100 TO \$499

Airey, Dick & Edna
Allen, Reuben & Janice
Amaro, Janet
Atkinson, Peg
Balas, Bernard & Betsy
Ballantine, James & Margaret*
Bell, Bill & Pat
Benzon, Eggert & Agneta
Blanton, Jesse & Kelly
Bloedorn, Philip
Boyd Family Foundation
Bradley, Ralph & Pam
Briley, Clint & Doris
Brown, Pamela
Burdick, Ed & Bonnie
Burton, Dick & Nancy
Cardwell, Blake & Gertrude
Carl, John & Brook
Chadwick, Gary & Sharon

Church, Chuck & Hiromi
Clarke, George & Eleanore
Clow, Stanley & Jane
Coleman, Betty
Craig, Bill & Jessica
Crawford, Jean
Cunningham, Don & Carol
Davis, Dave & Suzanne*
Dew, Jimmy & Toni
DeTurk, Fred & Carolyn
Diemer, Marc & Robbie
Eakes, Tom
Everts, Ray & Regine
Faudree, Russell
Field, Bill & Perry
Fiorillo, Frances*
Fulk, R.V. & Judy
Garrett, Ken & Kathy
Gibson, Bruce & Karen
Girardi, Joe & Nan
Gischel, Gary & Betty
Gordon, Barry & Louise
Graham, Adair
Gunther, Ron & Marilyn
Guys, Raymond & Milta
Hardy, Wilson & Virginia
Hawkins, James & Barbara
Hawkins, Richard & Margaret
Helgesen, Henry & Marianne
Hopper, Dick & Barbara
Hovdesven, Arne & Helen
Jane, Jean
Joens, Ray & Sue
Johnson, Richard & Kapricia
Jones, Warren & Kathleen
Kantz, Philip & Barbara*
Kapsa, Dick
Kates, Jon & Sandra
Kiefhaber, Ed & Nancy
Kitchens, Elizabeth
Kress, Ray & Margaret
Larson, Judith
Lawson, Ferd & Martha
Littlejohn, John & Mary
Malone, Doug & Lois
Matthews, Jim & Diana
McMillan, Bill & Frances
McMillan, Tom & Antoinette
McTigue, Pat & Carol
Meder, Joe & Gloria

Meyers, Jim & Loretta
Meehan, Peter and Prudence
Meyers, Jim & Loretta
Milligan, Jack & Beryl
Moen, Wanda
Moro, Dom & Dolores
Morris, Jim & Debby
Murphy, Gene & Jeanne
Nawrocki, Stan & Peggy
Nelson, Larry & Sue
Newsom, Al & Gladys
Owens, Chuck & Josie*
Pearson, Chuck & Betty
Robinson, Ken & Barbara
Rodgers, Joan
Rodilosso, Phil & Nancy
Schorschinsky, Florence
Schwerdt, Kurt & Carla
Smith, Brian and Peggy
Smith, Nancy
Snow, Phyllis
Strahl, Wolfgang & Gerda*
Stauffer, Bill & Jean
Stewart, Stu & Stevie
Tomlinson, Addie
Turton, Bob & Debra
VanArsdale, Tom & Susette
Verrone, Dick & Carol
Vincent, Jon & Deedy
Werner, Elaine
White, Dick & Mearlene
Wilson, Frances
Wingerter, Gene & Bobbie
Winston, John & Pat
Wixom, Everett & Virginia
Woodbury, Max & Joanne

DONATIONS UP TO \$99

Candler, Chris & Sue
Cline, Richard & Barbara
Dixon, Gray & Marion
Ingram, Roy & Philippa
Jacobson, Ron & Janus
Leister, Jack & Anne
Long, Susan
Metzger, Charles & Loretta
Morrell, Louis & Ruth Ann
Rosenberg, Irwin & Cynthia

* In honor or memory of (next page)

Endowment Fund Progress

By Ken Garrett

The Endowment Fund for the Frank H. Kenan Chapel at Landfall was established about three years ago with a generous initial contribution from the Kenan Family Foundation. The purpose of the Fund, after it reaches the goal of \$300,000, is to use part of the income to help cover the expenses of the Chapel in perpetuity. The invested principle would remain untouched to grow over time. The Fund will go a long way toward ensuring that the Chapel continues to be a strong, positive element for service to Landfall and the greater Wilmington area well into the future.

Through your generous support the Endowment Fund has grown; however, your continuing contributions are needed to help reach the goal. Four of the ways you can give to provide support to the Chapel Fund are:

- 1) Sending a check to the Chapel along with the contribution form included in this newsletter
- 2) Using publicly traded stock to make a contribution
- 3) Providing an initial contribution with a pledge to make additional contributions over time up to a certain amount
- 4) Using a distribution from your IRA if you are eligible.

Contributions are tax deductible and in the case of publicly traded stock or an IRA distribution contributions may provide additional tax advantages.

For donations of \$1,000 or more a recognition area of engraved brick markers has been established on the grounds underneath the stained glass rose window at the rear of the Chapel. If you provide a pledge of \$1,000 or more over four years or less a marker will be reserved for you and engraved on completion of the pledge. Currently, over half the markers have been engraved and we would really like to engrave one with your name or the name of a loved one. Please contact Bill Stauffer (910-256-9900, email BillStauf@aol.com) or any Board member to discuss a gift. We greatly appreciate your generosity.

GIFTS TO HONOR

* The following contributions from the preceeding page were made in memory of or in honor of:

E. BLAKE CARDWELL
From John & Judy Talbert

ANNE DAVIS
From Dave & Suzanne Davis

MR. & MRS. CHRIS ELLIS
From James & Margaret Ballantine

MICHAEL FIORILLO
From Frances Fiorillo

ED GOLDMAN
From LTG & Mrs. Ira C. Owens

AUSTIN L NEWSOM
From Mat & Pat White

TONY GADDY & TED OLDS
From Ned & Carol Olds

MONIKA STRAHL
From Wolfgang & Gerda Strahl
From Philip & Barbara Kantz

Note: Taxpayers 70-1/2 or older can transfer as much as \$100,000 a year directly from an IRA to a charity without owing income taxes on the money. The transfer counts as part of the required minimum distribution for the year, and, if the donation goes directly from an IRA to a designated charity, none of that amount will be taxed.

FRANK H. KENAN CHAPEL CONTRIBUTION FORM

Donation from (print name(s) as it should appear): _____

I have enclosed a check in the amount of: \$ _____. I wish my donation to be directed for (check all that apply):

Unrestricted Endowment Music Program Memorial Garden Maintenance and Expansion

I wish to donate Securities. Please contact me by phone or email: _____

If your donation is be made to honor or in memory of someone, please complete the following:

This donation is (check one): In Honor of, or In Memory of: _____

If you wish the Kenan Chapel to notify the family of the person so remembered, please provide the name and address and any additional information for the notification letter.

Please mail this form to:

THE FRANK H. KENAN CHAPEL, 510 ARBORETUM DRIVE, WILMINGTON, NORTH CAROLINA 28405

All gifts are tax deductible. The Kenan Chapel is a 501(c)(3) charitable organization.

FRANK H. KENAN CHAPEL AT LANDFALL

510 Arboretum Drive
Wilmington, North Carolina, 28405
910-256-9578
www.kenanchapel.com



Entrance to the Memorial Garden

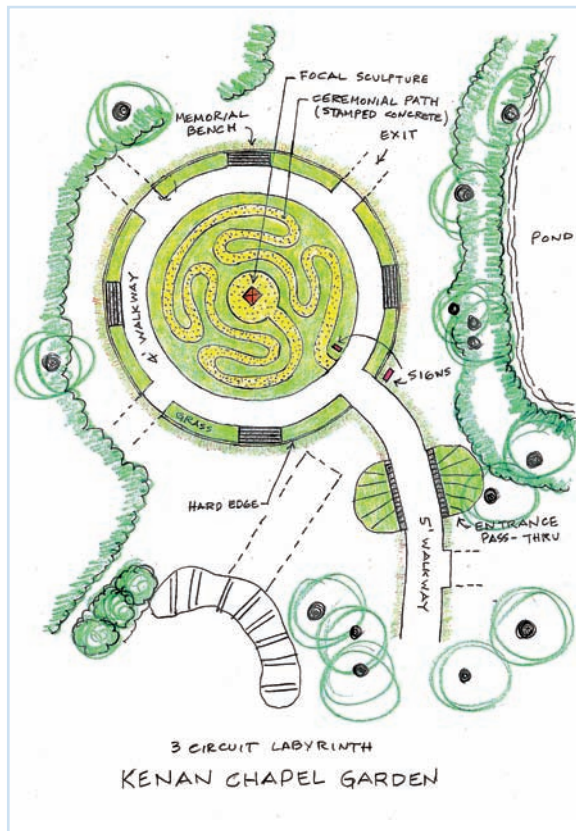

Proposed Labyrinth for Memorial Garden

NEWSLETTER PRODUCTION

Publisher:
Al Newsom

Editor:
Pat Bell

Contributors:
Ken Garrett
Kate Keenan
Marlyn Sager

Photography Courtesy of:
John Beausang
Pat Bell
Dick Parrott (wedding picture)
Priscilla Rogers

Design & Production:
Avery Wilmeth

Printing:
Linprint